

Cilindrische draaiende handgrepen

Duroplast

MATERIAAL

Op fenol gebaseerd (PF) duroplast, zwarte kleur, glanzende afwerking.

STANDAARDUITVOERING

- **I.281**: glad doorvoergat.
- **I.281+x**: mat verchroomde stalen schacht, cilindervormige kop met binnenzeskant.
- **I.281+x-SST**: AISI 304 roestvrijstalen schacht, cilindrische kop met binnenzeskant.
- **I.281+x+Gh**: mat verchroomde stalen schacht, cilindervormige kop met binnenzeskant.

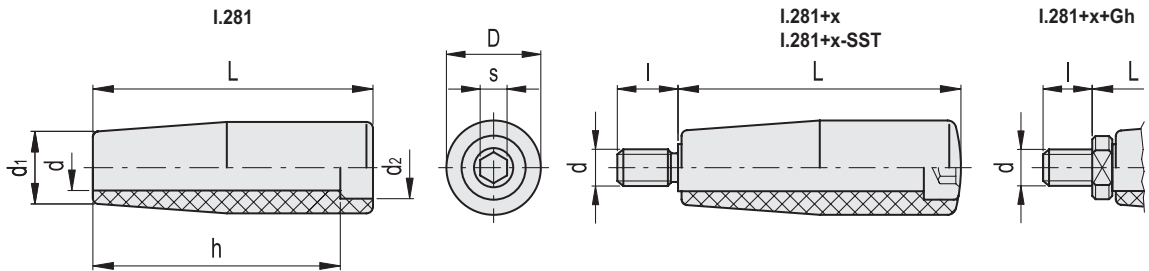

I.281

Code	Beschrijving	D	L	d	d ₁	d ₂	h	⚖
22301	I.281/40	18	39	8	15	12	35	10
22401	I.281/50	21	49	10	17	14	43	16
22501	I.281/65	23	64	12	19	16	56	24
22601	I.281/80	26	79	13	21	17	70	38
22701	I.281/90	28	89	14	22	19	79	50
22801	I.281/100	31	100	16	25	20	89	63

I.281+x

Code	Beschrijving	D	L	d _{6g}	d ₁	l	s	⚖
22311	I.281/40+x-M6	18	40	M6	15	13	4	29
22411	I.281/50+x-M8	21	50	M8	17	15	5	56
22511	I.281/65+x-M8	23	65	M8	19	17	6	88
22512	I.281/65+x-M10	23	65	M10	19	17	6	90
22611	I.281/80+x-M10	26	80	M10	21	18	6	134
22711	I.281/90+x-M10	28	90	M10	22	18	8	171
22811	I.281/100+x-M12	31	102	M12	25	20	8	243
22812	I.281/100+x-M14	31	102	M14	25	20	8	251

I.281+x-SST

STAINLESS STEEL

Code	Beschrijving	D	L	d _{6g}	d ₁	l	s	⚖
22312	I.281/40+x-M6-SST	18	40	M6	15	13	4	29
22412	I.281/50+x-M8-SST	21	50	M8	17	15	5	55
22513	I.281/65+x-M8-SST	23	65	M8	19	17	6	89
22514	I.281/65+x-M10-SST	23	65	M10	19	17	6	87
22612	I.281/80+x-M10-SST	26	80	M10	21	18	6	136
22712	I.281/90+x-M10-SST	28	90	M10	22	18	8	171
22813	I.281/100+x-M12-SST	31	102	M12	25	20	8	247
22814	I.281/100+x-M14-SST	31	102	M14	25	20	8	247

I.281+x+Gh

Code	Beschrijving	D	L	d _{6g}	d ₁	l	s	⚖
22321	I.281/40+x-M6+Gh	18	45	M6	15	8	4	32
22421	I.281/50+x-M8+Gh	21	55	M8	17	10	5	59
22521	I.281/65+x-M8+Gh	23	70	M8	19	12	6	92
22522	I.281/65+x-M10+Gh	23	71	M10	19	12	6	102
22621	I.281/80+x-M10+Gh	26	86	M10	21	12	6	143
22721	I.281/90+x-M10+Gh	28	96	M10	22	12	8	183
22821	I.281/100+x-M12+Gh	31	109	M12	25	13	8	259
22822	I.281/100+x-M14+Gh	31	109	M14	25	13	8	260

Vaste en draaibare handgrepen 5