

Rod controls

for CLT latches, steel

ROD GUIDES

Zinc-plated steel supplied with steel seeger.

TOOTHED WHEEL

Zinc alloy with superficial chromate treatment.

STANDARD EXECUTIONS

- **CAR-M-347**: nickel-plated zinc alloy.
- **CAR-TP-347**: glass-fibre reinforced polyamide based (PA) technopolymer.

ACCESSORIES ON REQUEST

Rod control CAR. are used in combination with latches with handles CLT. (see page -) to be ordered separately (see the assembly drawing).

Other accessories available on request:

- C.GAT: pair of polyamide based technopolymer (PA) rod guides, one rod guide per 500 mm rod length.
- C.AT: pair of galvanized steel flat rods, cross section 14x3 mm, length 1,000 mm and black technopolymer end wheels, for frame thicknesses of 20 and 25 mm.

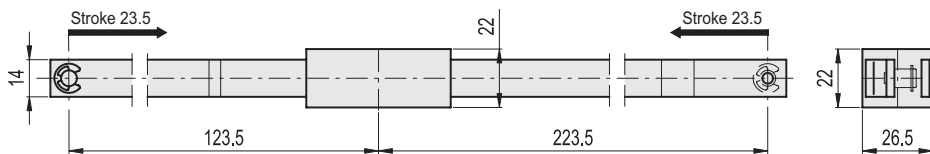
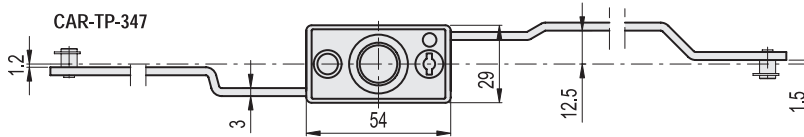
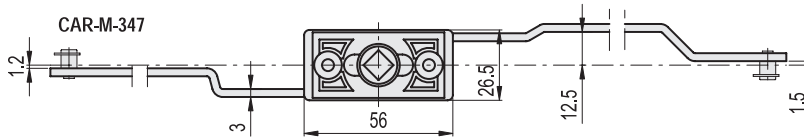
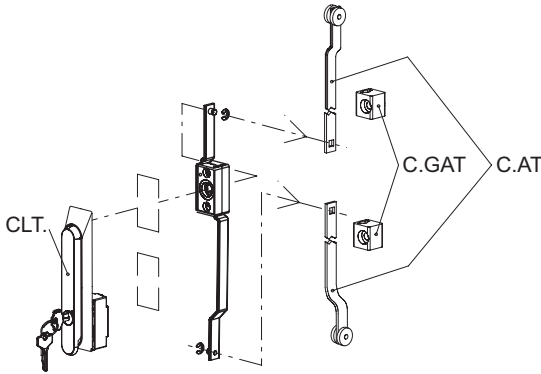

CAR-M

Code	Description	⚖️
420031	CAR-M-347	212

CAR-TP

Code	Description	⚖️
420032	CAR-TP-347	161